

# INT280 B® Diagnose

## INT280 B® Diagnose

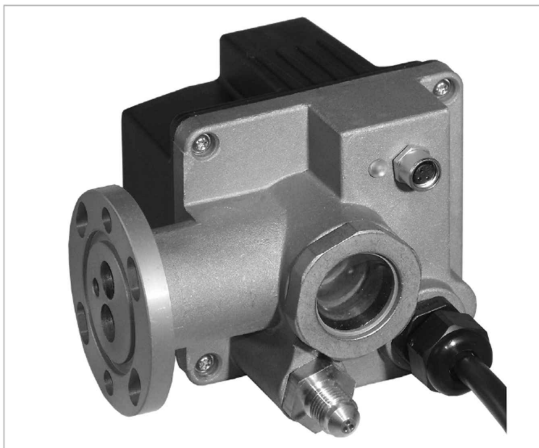

INT280 B Diagnose

### Application

The INT280 B Diagnose is a further development of the reliable KRIWAN oil level regulators.

The oil level regulator monitors and controls the oil level in the refrigerant compressors. The problem of poor oil distribution in multi-compressor packs has been overcome by actively supplying oil from the oil reservoir. This minimizes the risk of operating without enough oil in the compressor.

The INT280 B Diagnose automatically saves operational and error data in a non-volatile memory. This data can be retrieved and analysed for diagnosis.

### Functional description

The oil level is monitored optically at half the height of the sight glass.

If the oil level is too low, the intelligent filling algorithm controls the oil refill. To do this, the integrated solenoid valve is opened cyclically.

The oil level regulator turns the motor off via the internal relay if the oil level remains too low after a longer period of time. After this, the oil continues to be refilled.

When the oil has reached a sufficient level, the relay activates so that the motor can restart.

The reactions are time delayed, to prevent unnecessary switching in response to temporary fluctuations in the oil level.

The integrated LED signals the current status.

For operation in accordance with regulations, the INT280 B Diagnose must be continuously supplied with the specified supply voltage.

The mounting, maintenance and operation are to be carried out by an electrician. The valid European and national standards for connecting electrical equipment and cooling installations have to be observed. Connection lines that extend from the terminal box have to feature at least a basic insulation.

The user has to ensure that the connections are properly tight. The electrical connection needs to be carried out according to the wiring diagram.

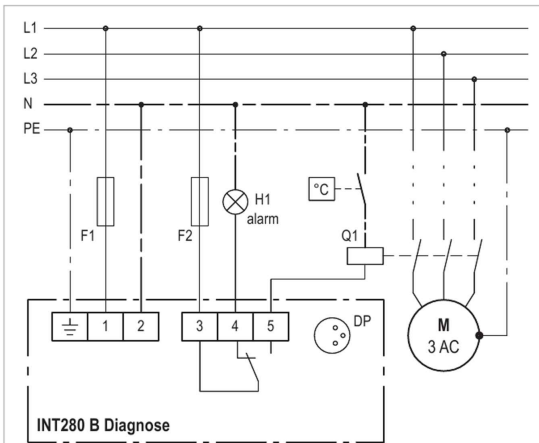

Wiring diagram

### Overview flash code

Level OK	Green illuminates
Filling	Green flashes
Oil level too low	Red illuminates
Internal error	Red flashes

See back side for further specifications

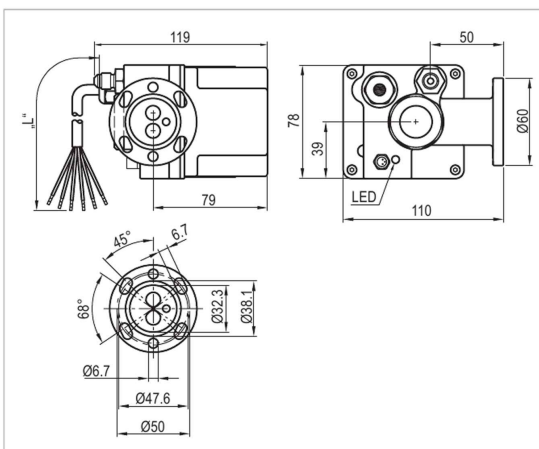

Dimensions in mm

Technical changes reserved



# INT280 B<sup>®</sup> Diagnose

## INT280 B<sup>®</sup> Diagnose

### Technical specifications

Supply voltage	AC 50/60Hz 230V ±10% 15VA
Permitted ambient temperature	-30...+60°C
Permitted rel. humidity	10-95% r. h. no condensation
Medium temperature	-30...+100°C
Operating pressure	-1...+50bar
Test pressure	75bar
Differential pressure	1-25bar (through valve)
Relay	
- Contact	AC 240V 2.5A C300 at least AC/DC 24V 20mA
- Mechanical service life	Approx. 1 million switching cycles
Interface	Diagnose port (DP)
Protection class acc. to EN 60529	IP54 (DP cable or cover has to be installed)
Supply	
- electrical	Cable 6xAWG 18, L=1m
- Oil	7/16"-20 UNF
Mounting	Flange (3-/4-hole)
Housing material	Anodised aluminium PA glass-fibre-reinforced
Flow rate through valve	1l/min (water 20°C, 1bar differential pressure)
Oils	Mineral and ester oils without additives
Refrigerant	Non-corrosive, non-flammable
Mounting position	Horizontal (rotatable by 180°), ±2°
Dimensions	Refer to dimensions in mm
Weight	Approx. 950g
Check base	EN 61000-6-2, EN 61000-6-3 EN 61010-1 Overvoltage category II Pollution level 2

### Order data

INT280 B Diagnose	<b>52 S 481</b>
Accessories and application information	see <a href="http://www.kriwan.com">www.kriwan.com</a>