

Pressure separator with taper fitting or threaded adaptor DIN 11 851 (milk pipe fitting)

Type 409772

Diaphragm pressure separator Type 409772/17-...

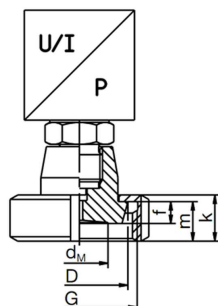

Technical data

Process connection	Nominal pressure bar	Recommended min. pressure range bar	Temperature coefficient mbar/10°C	Weight (without meas. device) kg	Dimensions [mm]					
					d _M	D	thread G	f	m	k
DN25	PN40	above 6	+20	0.50	28	44	Rd 52 x 1/6	10	18	21
DN32		above 2	+12	0.65	34	50	Rd 58 x 1/6			
DN40		above 0.4	+6	0.73	38	56	Rd 65 x 1/6			
DN50	PN25	above 0.1	+3	1.10	46	68	Rd 78 x 1/6	11		22

Pipe pressure separator Type 409772/18-...

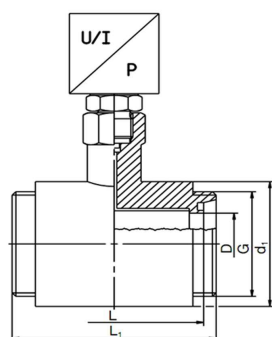

Technical data

Process connection	Nominal pressure bar	Recommended min. pressure range bar	Temperature coefficient mbar/10°C	Weight (without meas. device) kg	Dimensions [mm]				
					L	L ₁	D	thread G	d ₁
DN40	PN40	above 0.4	+6	3.20	126	140	38.0	Rd 65 x 1/6	78
DN50		above 0.1	+3	2.55	100	114	50.7	Rd 78 x 1/6	88

Order details

	(1) Basic type
409772	pressure separator with taper fitting DIN 11 851 or threaded adaptor DIN 11 851
	(2) Basic type extension
17	diaphragm pressure separator with taper fitting and ring nut
18	pipe pressure separator with threaded adaptor
	(3) Process connection
604	DN25 ¹
605	DN32 ¹
606	DN40
607	DN50
	(4) Nominal pressure in bar
025	PN25 ¹
040	PN40
	(5) Material
20	st. steel
99	special material ²
	(6) Filling liquid
1	silicone oil
2	inert liquid
3	vegetable oil
	(7) Capillary
0000	no capillary
0001	with cooling device
1000	1.0 m capillary
1500	1.5 m capillary
2000	2.0 m capillary
3000	3.0 m capillary
5000	5.0 m capillary

	(1)	(2)	(3)	(4)	(5)	(6)	(7)						
Order code	409772	/		-		-		-		-		-	
Order example	409772	/	18	-	606	-	040	-	20	-	3	-	1500

¹ only for pressure separators with taper fitting (basic type extension 17)

² please specify in plain text when ordering